

BETTER BY
DESIGN

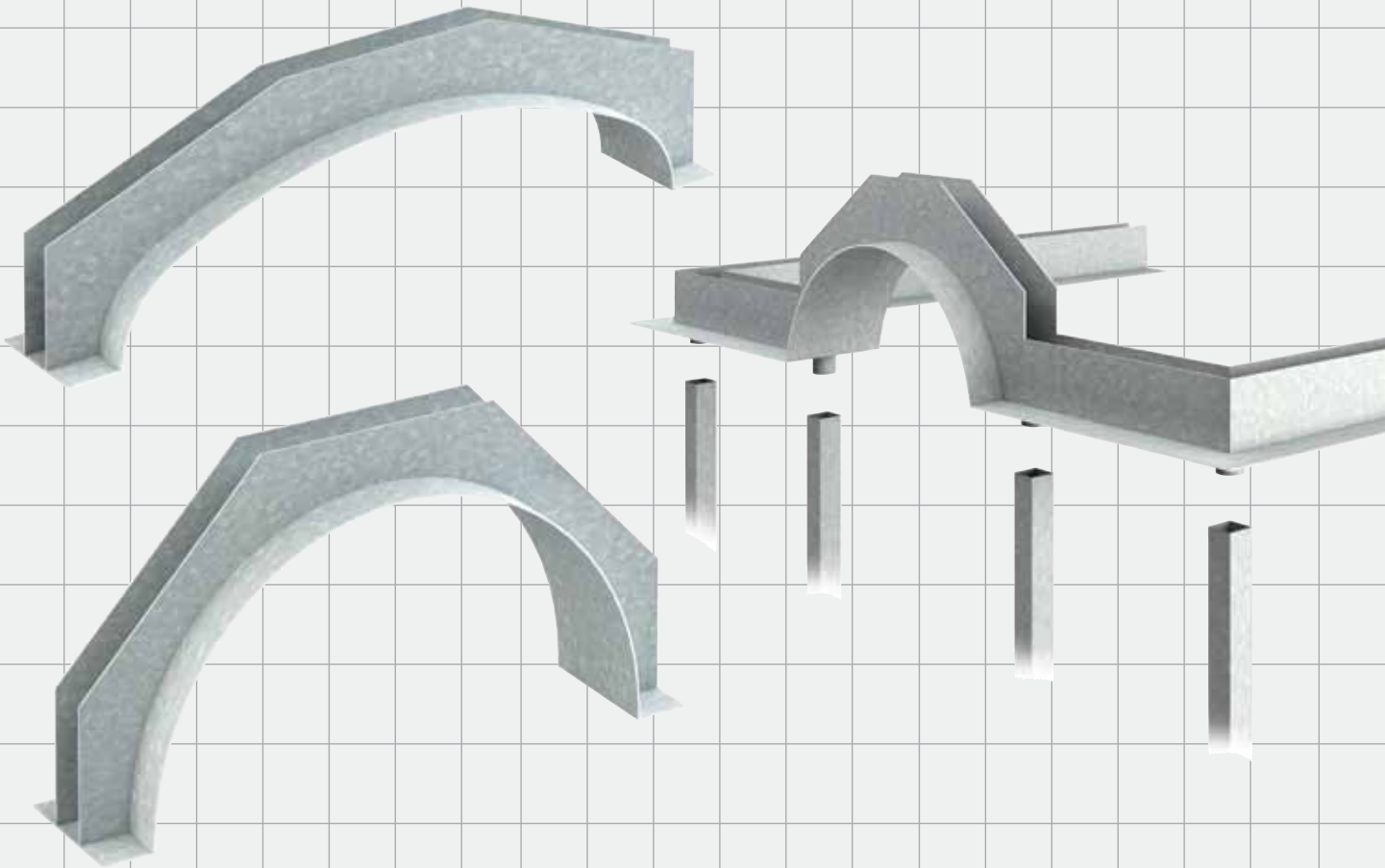

LINTEL SPECIALS & SUN LOUNGES

TAILOR MADE LINTELS | SUN LOUNGE SOLUTIONS





BETTER BY DESIGN

IG is renowned for supplying custom made lintel specials with the industry's shortest lead times backed by an innovative design service.



BBA Certification



British Standards Institution
ISO 9001 & ISO 14001



Home Builders
Federation



National Building
Specification Approved



RIBA CPD
Approved



Builders Merchants
Federation



National House
Building Council



INVESTORS IN PEOPLE

Investors in People
Accreditation



Building Research
Establishment

www.iglintels.com

Lintel Specials and Sun Lounges

CONTENTS	PAGE
Support & Service	04
Full Arch Lintel	06
Segmental Arch Lintel	07
Parabolic Arch Lintel	08
Venetian Arch Lintel	09
Apex & Half Apex Lintel	10
Gothic Arch Lintel	11
Corner Lintel	12
Bow Lintel	14
Splayed Bay Lintel	15
Square Bay Lintel	16
SUN LOUNGES LINTELS	
Sun Lounge Lintels	18
Sun Lounge Benefits	20
Sun Lounge Lintel Variants	22
Sun Lounge Construction Data	30
Fax Back Enquiry Forms	32



IG Support

With the largest range and more support, IG has over 50 years experience in delivering effective service and solutions.



CUSTOM MADE LINTEL SPECIALS

Special lintels provide the client and architect with a means to personalize a building's design. For over 50 years IG have been manufacturing special lintels for the construction industry, helping to make buildings that little bit more special.

An IG special lintel is ideal when something bespoke is required, whether to provide a unique building feature, or to carry an unusual loading condition. With a dedicated team of engineers, IG assesses the loading conditions and then designs the structural lintels, tailor made to the requirements and constraints of the individual project, in the most cost effective manner.

From parabolic, segmental, gothic and full arch lintels, bows, bays, corners and sun-lounge lintels the sky is the limit with IG's Special Lintel range.



SUN LOUNGE LINTELS

The construction of a Sun Lounge has been simplified by the introduction of an IG Lintel. It is a one piece unit which eliminates the need for local engineering, allows architects to design the Sun Lounge to suit the property, and will keep the cost sensible.

A Sun Lounge Lintel is an easy way to add space at low cost when building a new house, or extending a property. An extra room rather than an add-on, a Sun Lounge is comfortable all year round while allowing you to watch the seasons come and go in comfort.

A Sun Lounge will blend with the existing appearance of your home. It's easy to construct, using materials similar to your house. Also, it adds genuine floor space, it is structurally sound and adds value immediately.

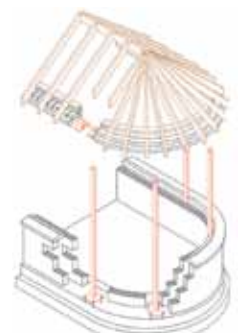

IG gives a hassle free service from enquiry stage through to delivery on site. You can relax in the knowledge that your order is in the hands of experts.



TECHNICAL SUPPORT

IG provides comprehensive technical support for all products. Our free scheduling and specification service offers fast turnaround on standard lintels, masonry support and windpost systems.

IG leads the market with a bespoke design service for special lintels and brickwork feature lintels, including onsite measurement and technical assistance.

By contacting our engineers at an early stage of your design process, you will potentially gain significantly more design flexibility for the overall project. Please send your drawings to: drawings@igintels.com

Please refer to our Fax Back Forms for special lintel requirements. Detailed measuring advice and Fax Back Enquiry Forms are available from igintels.com/support or alternatively you may submit your enquiry at www.igintels.com/special-lintels

FASTRACK DATABASE FOR CAD

The IG Fastrack Database is accessible from the IG website and provides downloads of CAD files for a selection of IG Steel Lintels.

NBS PLUS

IG provides specification details via RIBA NBS Plus, accessible by subscribers to the NBS Plus system.

DELIVERY

IG's fast, efficient delivery service is renowned throughout the construction industry. Our logistics solution is recognised by our customers for superior supply chain management.

IG continues to provide the largest range of lintels available, with the shortest lead times in the industry. We have invested in large stock inventories at our three manufacturing and distribution centres reassuring our customers that all our standard lintels are instantly available upon request.

IG has revolutionised the steel lintel industry by manufacturing and delivering 'special' lintels with lead-times historically associated with ex-stock items.

IG products are available through a national network of merchant suppliers. For information of merchant suppliers in your area please visit our website at: www.igintels.com/merchants.

Full Arch Lintel



DIMENSIONS REQUIRED	
LINTEL DIMENSIONS	
CLEAR SPAN (a)	mm
RADIUS (r)	mm
END BEARING (c)	mm
PLASTER KEY REQUIRED (Please Tick)	
INSIDE ONLY	<input type="checkbox"/>
BOTH SIDES	<input type="checkbox"/>
NONE	<input type="checkbox"/>
WALL CONSTRUCTION	
OUTER LEAF	mm
CAVITY WIDTH	mm
INNER LEAF	mm
IMPORTANT NOTE: Very accurate measurements required.	

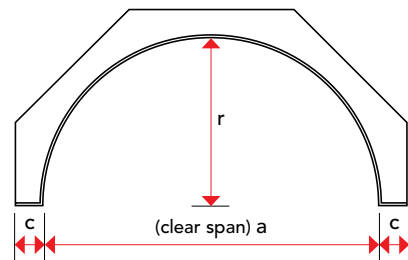

Segmental Arch Lintel



DIMENSIONS REQUIRED	
LINTEL DIMENSIONS	
CLEAR SPAN (a)	mm
RISE (r)	mm
END BEARING (c)	mm
PLASTER KEY REQUIRED (Please Tick)	
INSIDE ONLY	<input type="checkbox"/>
BOTH SIDES	<input type="checkbox"/>
NONE	<input type="checkbox"/>
WALL CONSTRUCTION	
OUTER LEAF	mm
CAVITY WIDTH	mm
INNER LEAF	mm
IMPORTANT NOTE: Very accurate measurements required.	

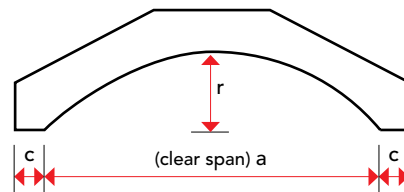

Parabolic Arch Lintel

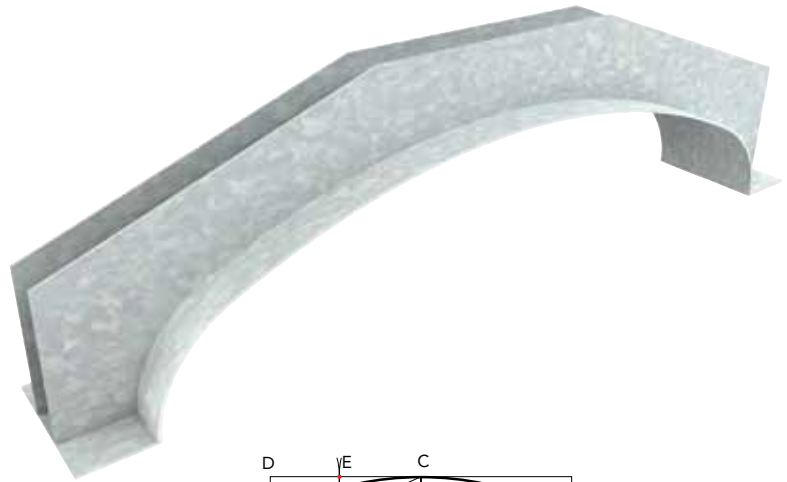

DIMENSIONS REQUIRED	
LINTEL DIMENSIONS	
CLEAR SPAN (a)	mm
RISE (r)	mm
END BEARING (c)	mm
PLASTER KEY REQUIRED (Please Tick)	
INSIDE ONLY	<input type="checkbox"/>
BOTH SIDES	<input type="checkbox"/>
NONE	<input type="checkbox"/>
WALL CONSTRUCTION	
OUTER LEAF	mm
CAVITY WIDTH	mm
INNER LEAF	mm
IMPORTANT NOTE: Very accurate measurements required.	

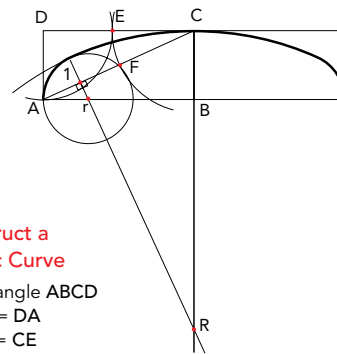

To construct a Parabolic Curve

Draw rectangle ABCD
 Make DE = DA
 Make CF = CE
 Bisect AF to make point 1
 Project a right angle off AF at point 1 to find small radius r, and project further to find large radius R

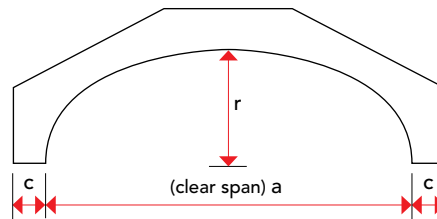
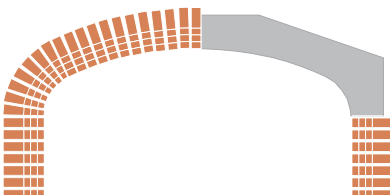

Venetian Arch Lintel



DIMENSIONS REQUIRED				
LINTEL DIMENSIONS				
OVERALL CLEAR SPAN (a1)	mm			
CLEAR SPAN (a2)	mm			
RISE (r)	mm			
END BEARING (c)	mm			
PLASTER KEY REQUIRED (Please Tick)				
INSIDE ONLY	<input type="checkbox"/>			
BOTH SIDES	<input type="checkbox"/>			
NONE	<input type="checkbox"/>			
SUPPORT POSTS (if required)				
HEIGHT	mm			
WALL CONSTRUCTION				
OUTER LEAF	mm			
CAVITY WIDTH	mm			
INNER LEAF	mm			
ARCH TYPE PLEASE TICK:				
<input type="checkbox"/> Full	<input type="checkbox"/> Segmental	<input type="checkbox"/> Parabolic	<input type="checkbox"/> Apex	<input type="checkbox"/> Gothic
IMPORTANT NOTE: Very accurate measurements required.				

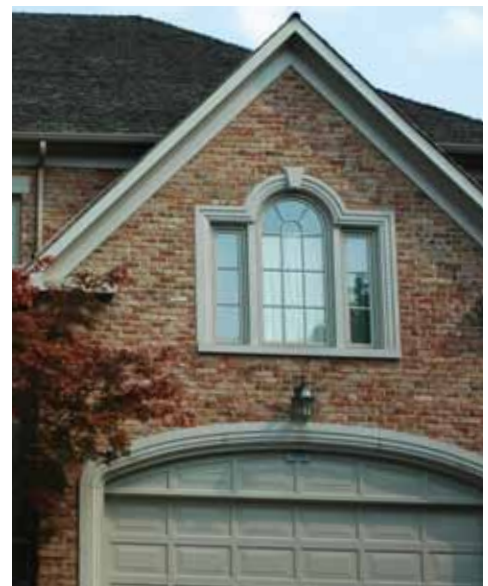
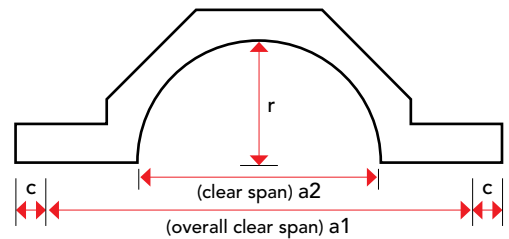

Apex & Half Apex Lintel



DIMENSIONS REQUIRED	
LINTEL DIMENSIONS	
CLEAR SPAN (a)	mm
RISE (r)	mm
END BEARING (c)	mm
PLASTER KEY REQUIRED (Please Tick)	
INSIDE ONLY	<input type="checkbox"/>
BOTH SIDES	<input type="checkbox"/>
NONE	<input type="checkbox"/>
WALL CONSTRUCTION	
OUTER LEAF	mm
CAVITY WIDTH	mm
INNER LEAF	mm
IMPORTANT NOTE: Very accurate measurements required.	

Apex Lintel

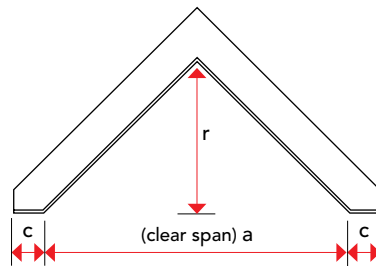

Half Apex Lintel

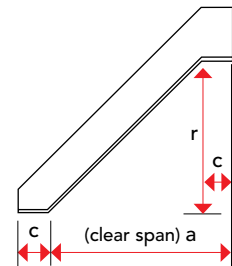

Gothic Arch Lintel

DIMENSIONS REQUIRED	
LINTEL DIMENSIONS	
CLEAR SPAN (a)	mm
RISE (r)	mm
END BEARING (c)	mm
RADIUS TYPE (Please Tick)	
SINGLE	<input type="checkbox"/>
DOUBLE	<input type="checkbox"/>
PLASTER KEY REQUIRED (Please Tick)	
INSIDE ONLY	<input type="checkbox"/>
BOTH SIDES	<input type="checkbox"/>
NONE	<input type="checkbox"/>
WALL CONSTRUCTION	
OUTER LEAF	mm
CAVITY WIDTH	mm
INNER LEAF	mm
SINGLE RADIUS (if known)	
RADIUS	
DOUBLE RADIUS (if known)	
LARGE RADIUS	
SMALL RADIUS	
IMPORTANT NOTE: Very accurate measurements required.	

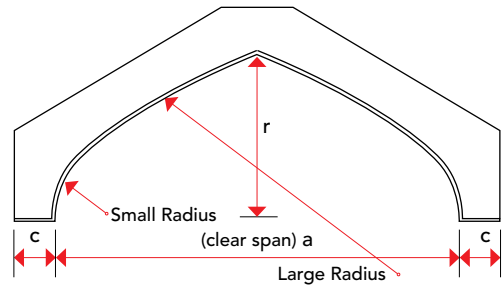
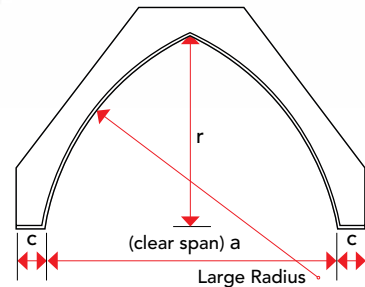
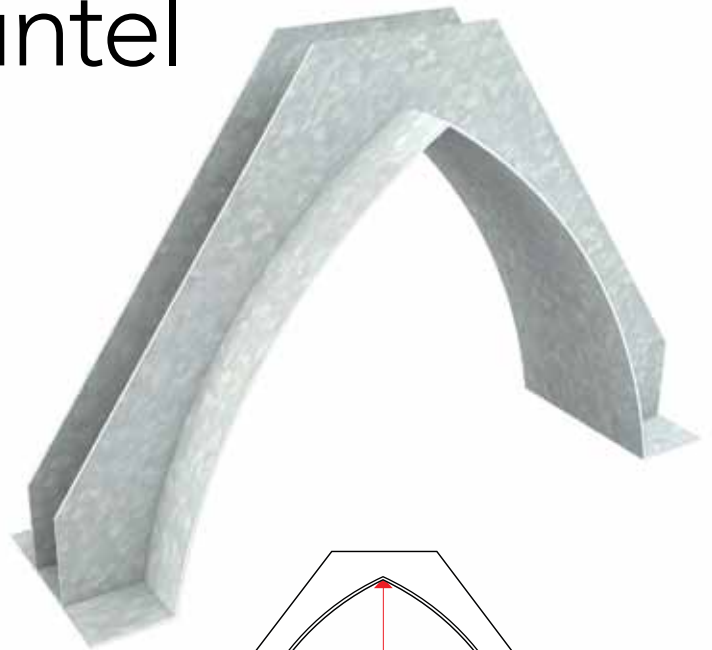

Corner Lintel

The IG Corner Lintel is supplied as a 'one piece' fully mitred and welded structural unit for easy installation.

STANDARD DUTY CORNER LINTEL



HEAVY DUTY CORNER LINTEL

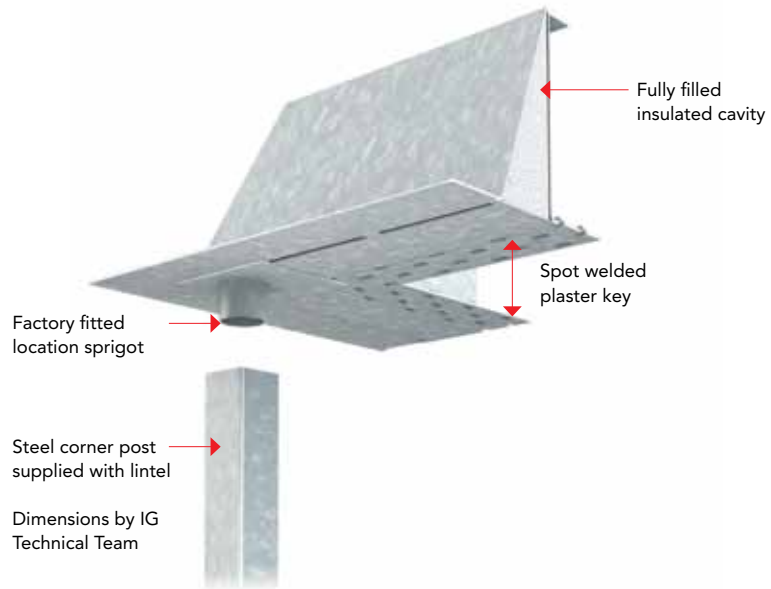

SECTION THROUGH CORNER AND POST SUPPORTED ON SUBSTRUCTURE

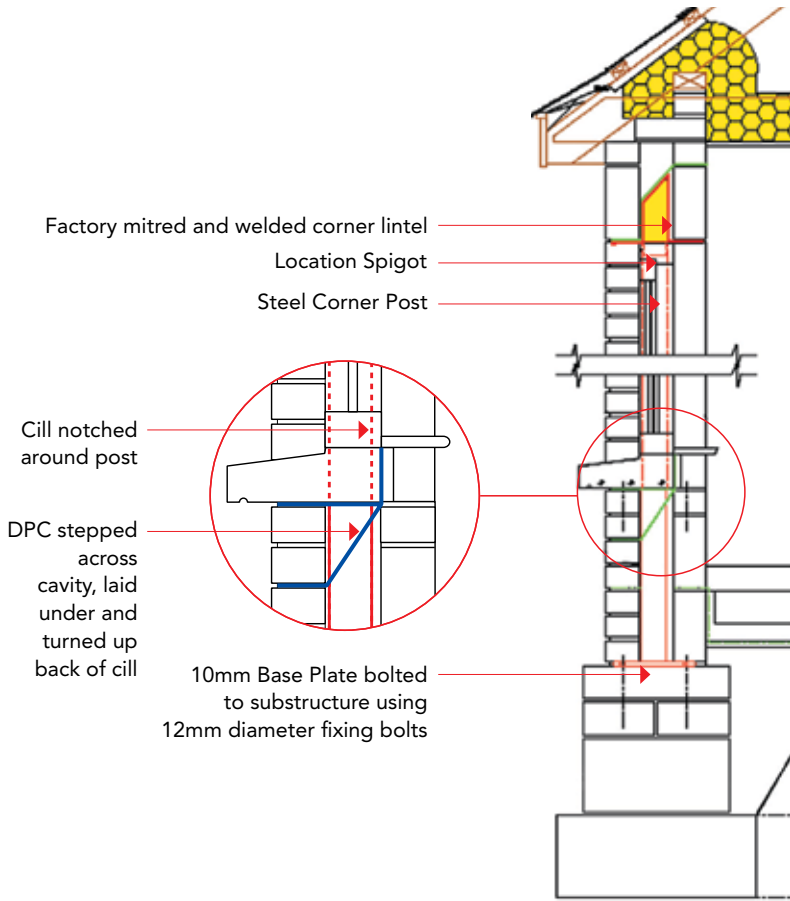

DIMENSIONS REQUIRED	
LINTEL DIMENSIONS	
A to B =	mm
B to C =	mm
A to C =	mm
PLASTER KEY REQUIRED (Please Tick)	
INSIDE ONLY	<input type="checkbox"/>
BOTH SIDES	<input type="checkbox"/>
NONE	<input type="checkbox"/>
WALL CONSTRUCTION	
OUTER LEAF	mm
CAVITY WIDTH	mm
INNER LEAF	mm
SUPPORT POST	
HEIGHT	mm
IMPORTANT NOTE: Do not allow for bearing, this will be added at manufacturing stage. Very accurate measurements required.	

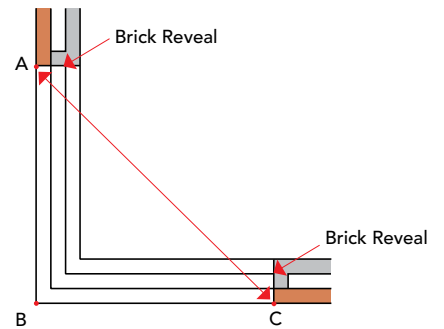

Bow Lintel



DIMENSIONS REQUIRED	
LINTEL DIMENSIONS	
A to B =	mm
C to D =	mm
REVEALS (Please Tick)	
PROJECTING	<input type="checkbox"/>
RETURNED	<input type="checkbox"/>
PLASTER KEY REQUIRED (Please Tick)	
INSIDE ONLY	<input type="checkbox"/>
BOTH SIDES	<input type="checkbox"/>
NONE	<input type="checkbox"/>
WALL CONSTRUCTION	
OUTER LEAF	mm
CAVITY WIDTH	mm
INNER LEAF	mm
SUPPORT POST	
HEIGHT	mm
IMPORTANT NOTE: Do not allow for bearing, this will be added at manufacturing stage. Very accurate measurements required.	

Bow Lintel with **Projecting Reveals**

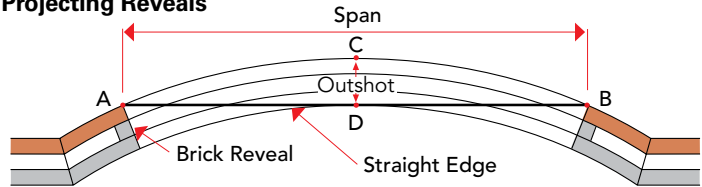

Bow Lintel with **Non Projecting Reveals**

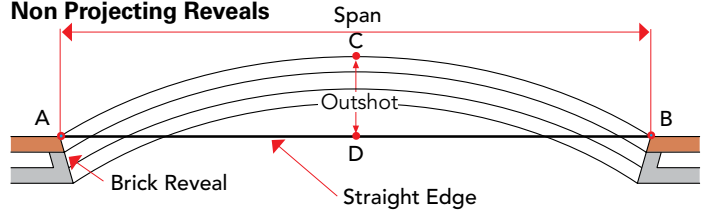

Splayed Bay Lintel



DIMENSIONS REQUIRED	
LINTEL DIMENSIONS	
A to B =	mm
B to C =	mm
C to D =	mm
A to D =	mm
A to C =	mm
B to D =	mm
REVEALS (Please Tick)	
PROJECTING	<input type="checkbox"/>
RETURNED	<input type="checkbox"/>
PLASTER KEY REQUIRED (Please Tick)	
INSIDE ONLY	<input type="checkbox"/>
BOTH SIDES	<input type="checkbox"/>
NONE	<input type="checkbox"/>
WALL CONSTRUCTION	
OUTER LEAF	mm
CAVITY WIDTH	mm
INNER LEAF	mm
SUPPORT POST	
HEIGHT	mm
IMPORTANT NOTE: Do not allow for bearing, this will be added at manufacturing stage. Very accurate measurements required.	

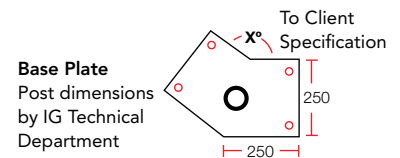
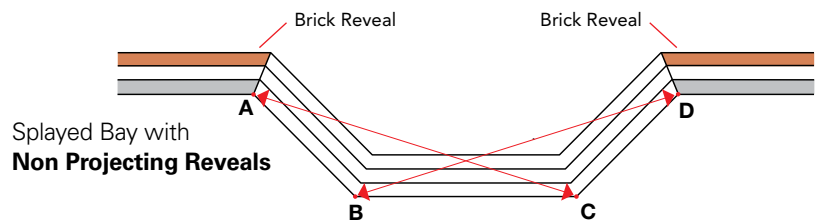
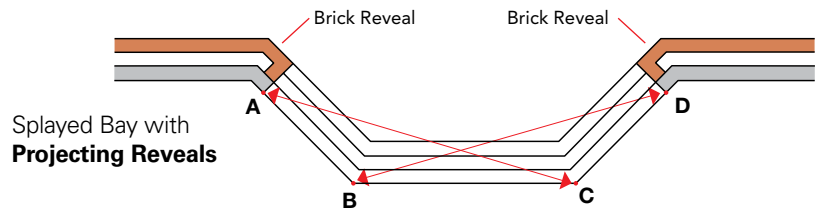

Square Bay Lintel

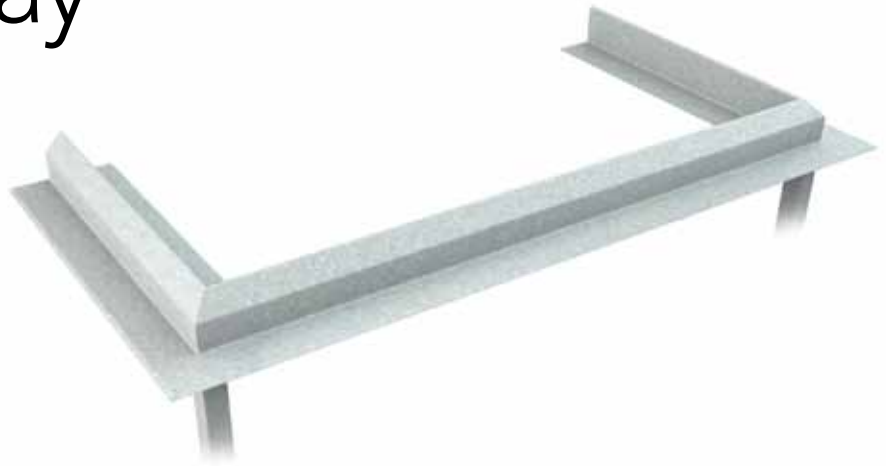

DIMENSIONS REQUIRED	
LINTEL DIMENSIONS	
A to B =	mm
B to C =	mm
C to D =	mm
PLASTER KEY REQUIRED (Please Tick)	
INSIDE ONLY	<input type="checkbox"/>
BOTH SIDES	<input type="checkbox"/>
NONE	<input type="checkbox"/>
WALL CONSTRUCTION	
OUTER LEAF	mm
CAVITY WIDTH	mm
INNER LEAF	mm
SUPPORT POST	
HEIGHT	mm
IMPORTANT NOTE: Do not allow for bearing, this will be added at manufacturing stage. Very accurate measurements required.	

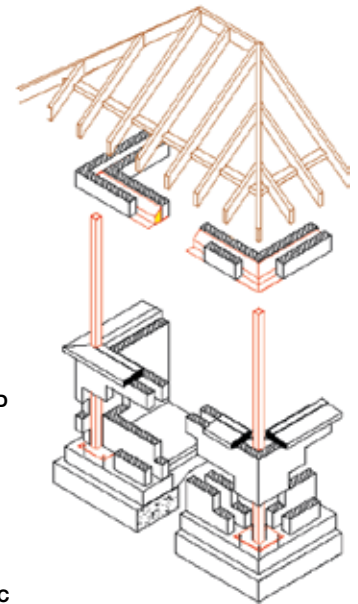
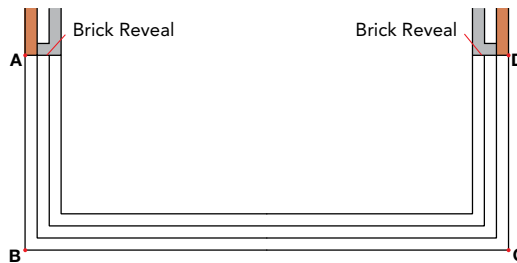
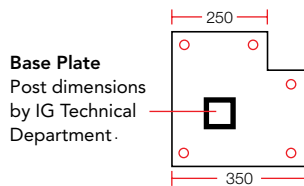

Whatever your requirements,
IG Engineers have the
experience and technical
expertise required to create
your special lintels.





Sun Lounge Lintels

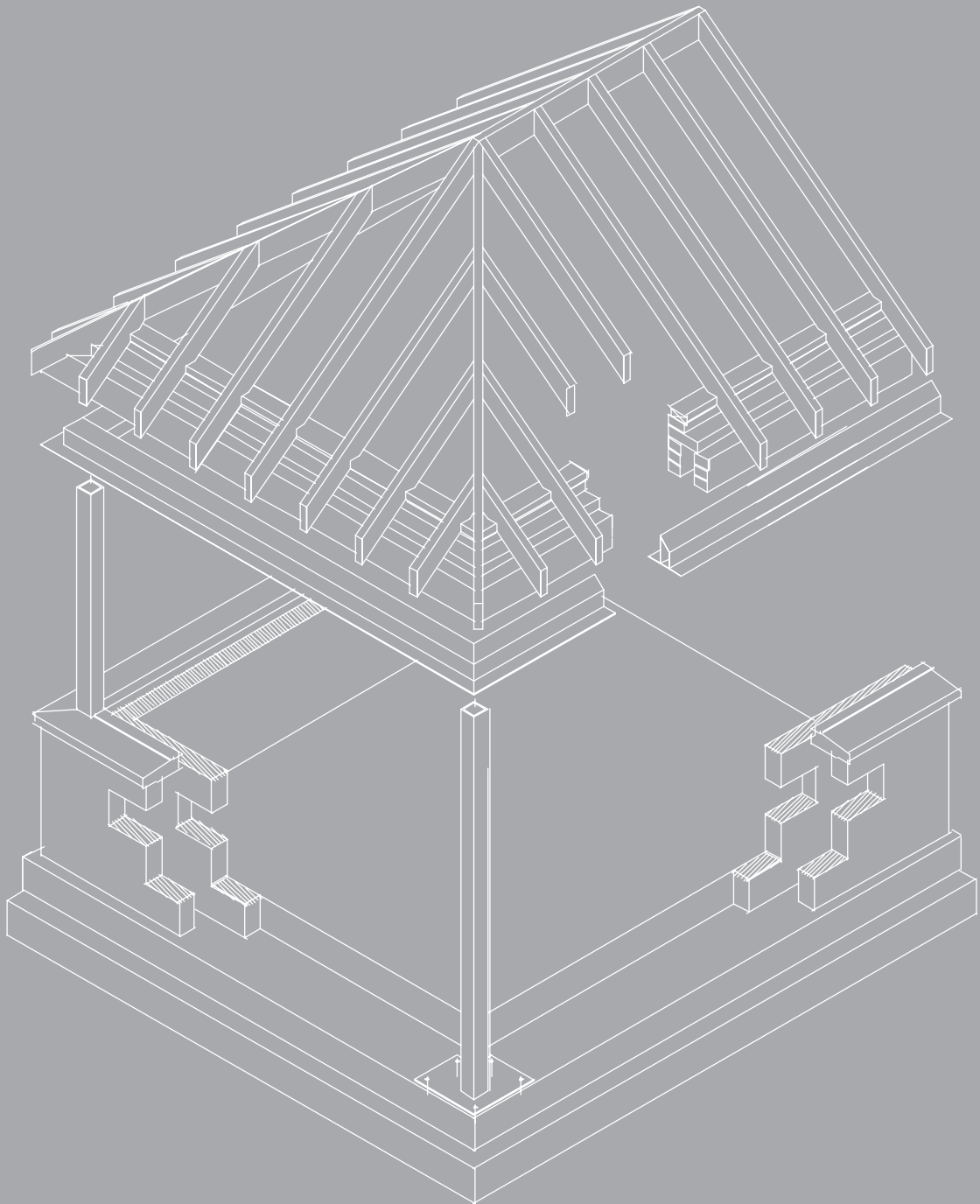

The construction of a Sun Lounge has been simplified by the introduction of an **IG Lintel**. It is a one piece unit which eliminates the need for local engineering, allows architects to design the Sun Lounge to suit the property, and will keep the cost sensible.



Benefits of adding a Sun Lounge

IG lintels ensure a seamless transformation.

It is universally recognised amongst home owners and house builders that a sun lounge is a more practical, user friendly room than a conservatory. Furthermore, a sun lounge floor area can be included in the overall measurement of your house size, adding much more value to your home.



WHAT DOES A SUN LOUNGE OFFER YOU?

A Sun Lounge Lintel is an easy way to add space at low cost when building a new house, or extending a property. An extra room rather than an add-on, a Sun Lounge is comfortable all year round while allowing you to watch the seasons come and go in comfort.

A Sun Lounge will blend with the existing appearance of your home. It is easy to construct, using materials similar to your house. Also, it adds genuine floor space, it is structurally sound and it adds value immediately.

WHAT DO IG OFFER?

The construction of a Sun Lounge has been simplified by the introduction of an IG Lintel. It is a one piece unit which eliminates the need for local engineering, allows architects to design the Sun Lounge to suit the property, and will keep the cost sensible.

The IG Sun Lounge Lintel is designed and delivered ready for erection.

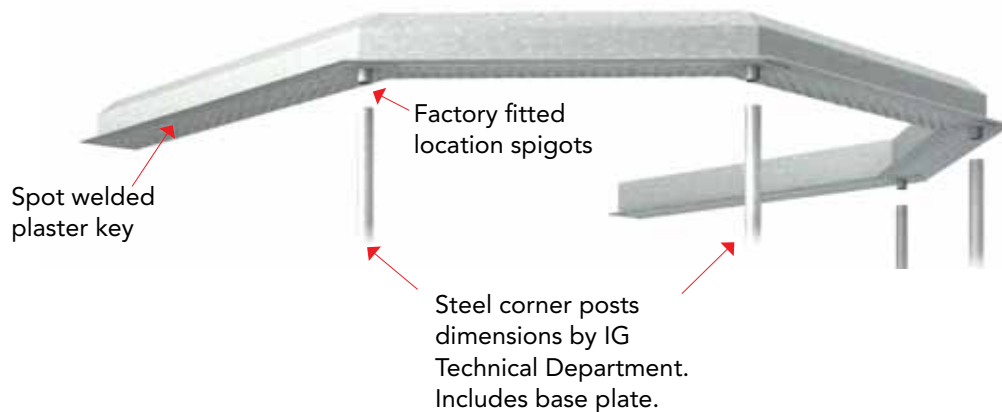

SUN LOUNGE OR CONSERVATORY?

A Sun Lounge is more competitively priced than a conservatory, is more visually appealing, is easier to clean, and is not a bolt on 'extra'.

- Much better heat retention in winter
- Protection from the summer sun
- Reduced noise compared to a conservatory roof



Standard Sun Lounge Lintel



STANDARD SIZES

SUN LOUNGE	INTERNAL WIDTH	INTERNAL WIDTH
Type A	3 metres	3 metres
Type B	3 metres	3.6 metres
Type C	3.6 metres	3.6 metres
Type D	3.6 metres	4 metres
Type E	4 metres	4 metres
Type F	3.6 metres	4.6 metres

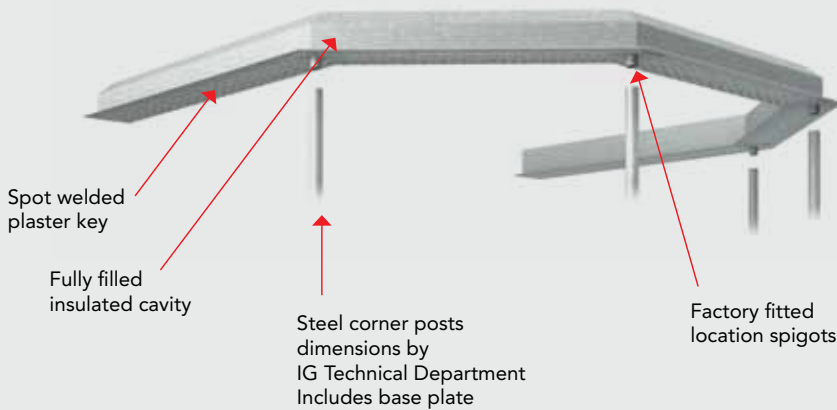
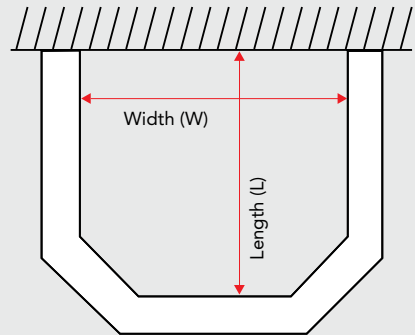

MAKING IT EASY

The sun lounge lintel can be supplied in any size to suit your requirements. FASTRACK AutoCAD files can be downloaded from our website at: www.iglintels.com/autocad

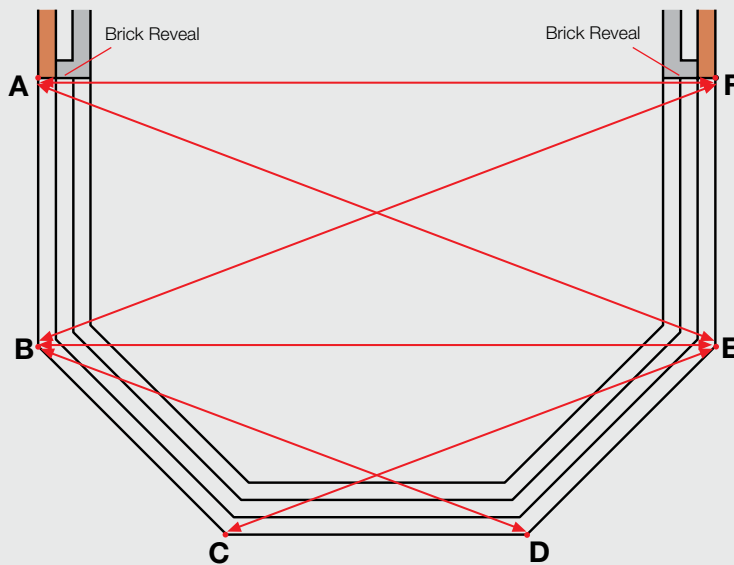

DIMENSIONS REQUIRED	
LINTEL DIMENSIONS	
A to B =	mm
B to C =	mm
C to D =	mm
D to E =	mm
E to F =	mm
A to F =	mm
A to E =	mm
B to F =	mm
B to E =	mm
C to E =	mm
B to D =	mm
PLASTER KEY REQUIRED (Please Tick)	
INSIDE ONLY	<input type="checkbox"/>
BOTH SIDES	<input type="checkbox"/>
NONE	<input type="checkbox"/>
WALL CONSTRUCTION	
OUTER LEAF	mm
CAVITY WIDTH	mm
INNER LEAF	mm
SUPPORT POST	
HEIGHT	mm



Apex Sun Lounge Lintel

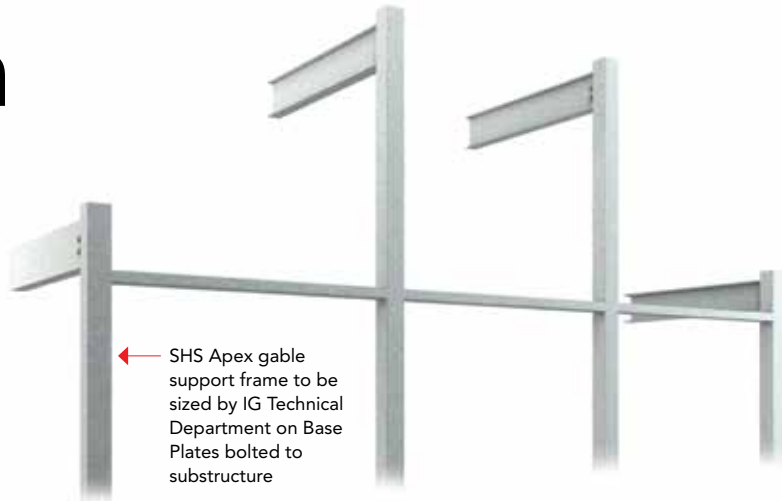

DIMENSIONS REQUIRED	
LINTEL DIMENSIONS	
A to B =	mm
B to C =	mm
C to D =	mm
C to E =	mm
OTHER DIMENSIONS	
Height from top of substructure to underside of lintels (H)	mm
External frame width of patio doors if applicable (W)	mm
Roof pitch	mm
IMPORTANT NOTE: Do not allow for bearing, this will be added at manufacturing stage. Very accurate measurements required.	

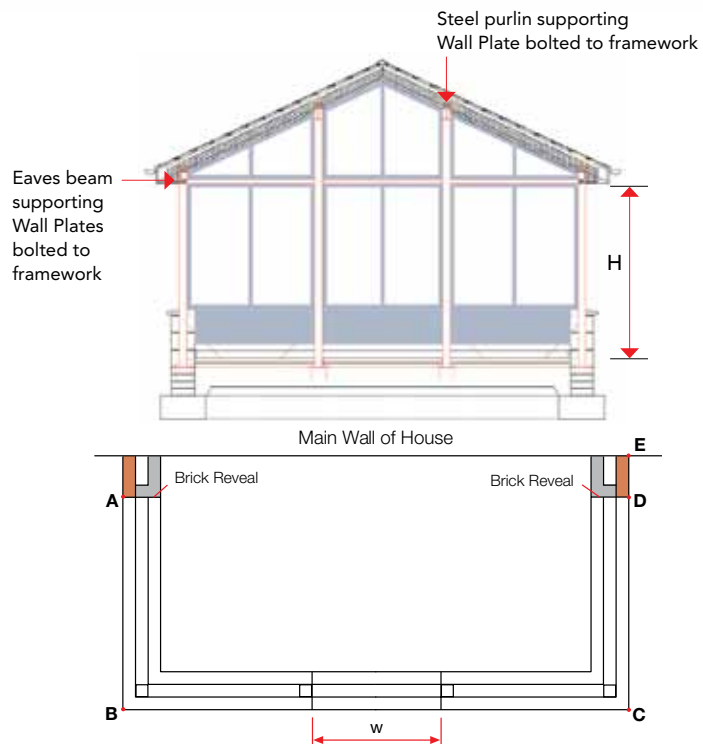

Venetian Sun Lounge Lintel



DIMENSIONS REQUIRED	
LINTEL DIMENSIONS	
A to B =	mm
B to C =	mm
C to D =	mm
ARCH DIMENSIONS	
ARCH SPAN (s) =	mm
RISE (r) =	mm
PLASTER KEY REQUIRED (Please Tick)	
INSIDE ONLY	<input type="checkbox"/>
BOTH SIDES	<input type="checkbox"/>
NONE	<input type="checkbox"/>
WALL CONSTRUCTION	
OUTER LEAF	mm
CAVITY WIDTH	mm
INNER LEAF	mm
SUPPORT POST	
HEIGHT	mm
SUN LOUNGE ARCH TYPE	
DESCRIPTION	
IMPORTANT NOTE: Do not allow for bearing, this will be added at manufacturing stage. Very accurate measurements required.	

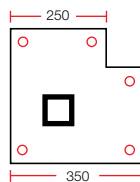

Base Plate
Post dimensions by IG Technical Department

Specify:
IG factory mitred and welded Venetian Arch Square Bay Lintel and posts with factory fitted location spigots for easy installation.

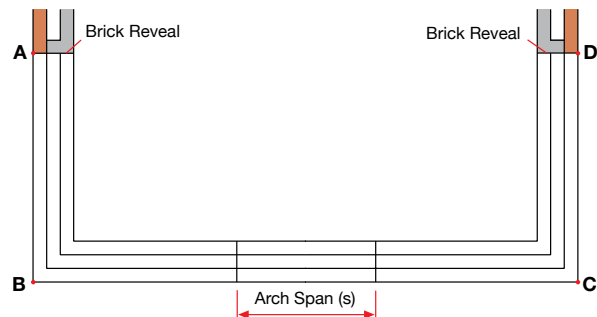

Bow Sun Lounge Lintel

DIMENSIONS REQUIRED	
LINTEL DIMENSIONS	
A to B =	mm
B to C =	mm
C to D =	mm
X to Y =	mm
X to Z =	mm
PLASTER KEY REQUIRED (Please Tick)	
INSIDE ONLY	<input type="checkbox"/>
BOTH SIDES	<input type="checkbox"/>
NONE	<input type="checkbox"/>
WALL CONSTRUCTION	
OUTER LEAF	mm
CAVITY WIDTH	mm
INNER LEAF	mm
SUPPORT POST	
HEIGHT	mm
IMPORTANT NOTE: Do not allow for bearing, this will be added at manufacturing stage. Very accurate measurements required.	

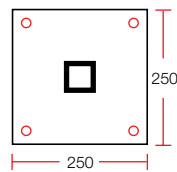

Base Plate
Post dimensions by IG Technical Department

IG Bow Lintel as specified by Technical Dept., factory fabricated and fitted with location spigots.

MS posts designed by IG Technical Dept. c/w Base Plate secured to substructure 300mm below finished floor level.

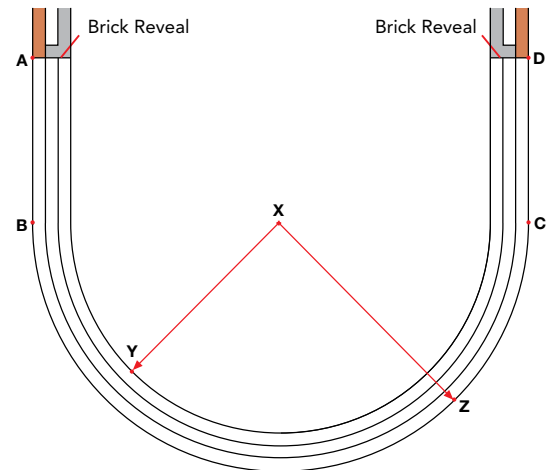
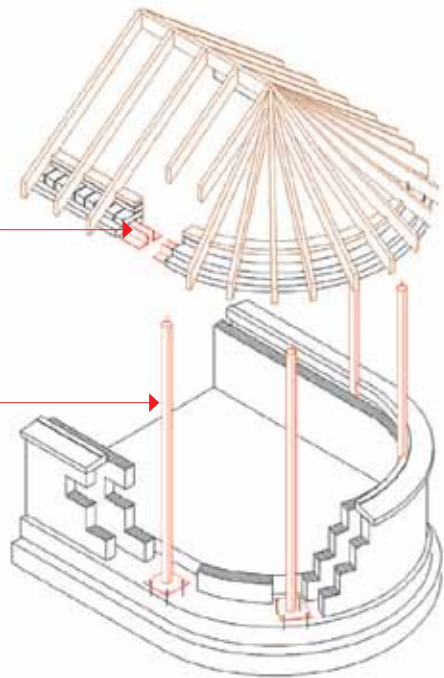

Square Bay Sun Lounge Lintel

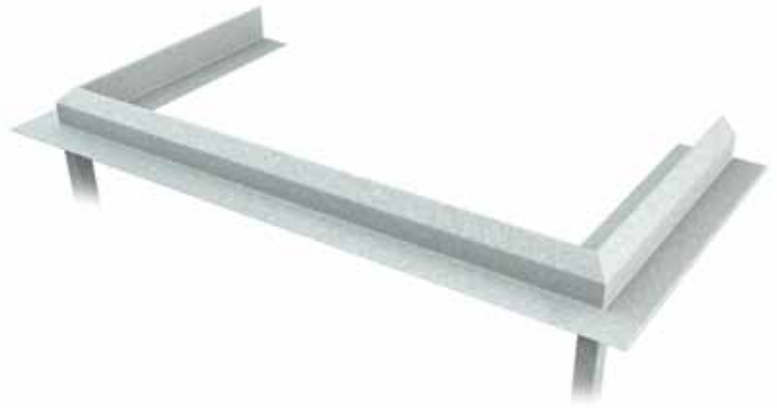

DIMENSIONS REQUIRED	
LINTEL DIMENSIONS	
A to B =	mm
B to C =	mm
C to D =	mm
PLASTER KEY REQUIRED (Please Tick)	
INSIDE ONLY	<input type="checkbox"/>
BOTH SIDES	<input type="checkbox"/>
NONE	<input type="checkbox"/>
WALL CONSTRUCTION	
OUTER LEAF	mm
CAVITY WIDTH	mm
INNER LEAF	mm
SUPPORT POST	
HEIGHT	mm
<p>IMPORTANT NOTE: Do not allow for bearing, this will be added at manufacturing stage. Very accurate measurements required.</p>	

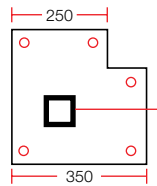

Base Plate
Post dimensions by IG Technical Department

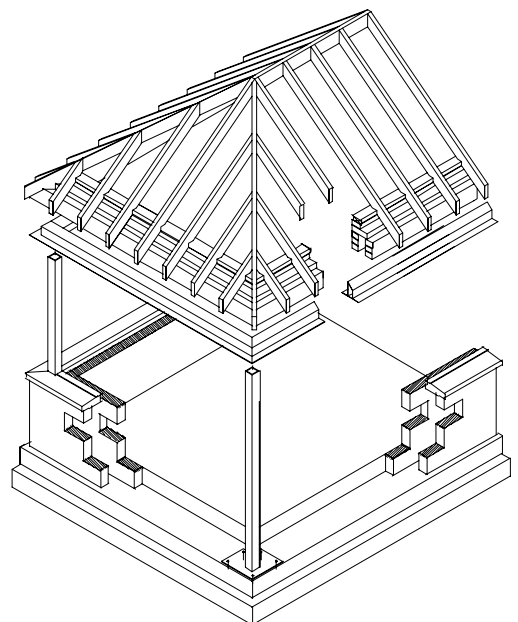
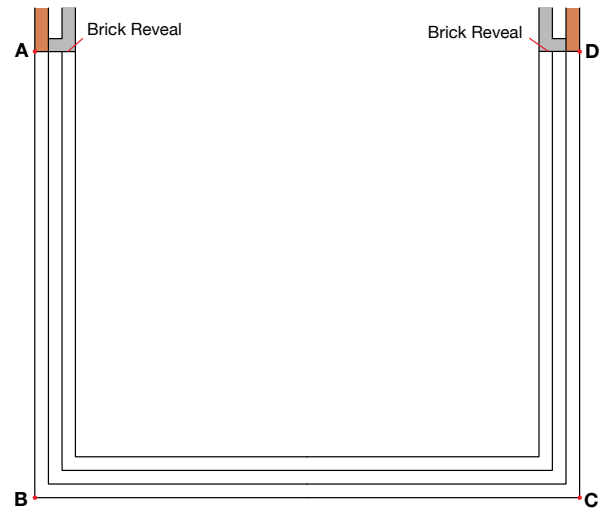

Ridge Beam Cradle

For cathedral or vaulted ceilings.

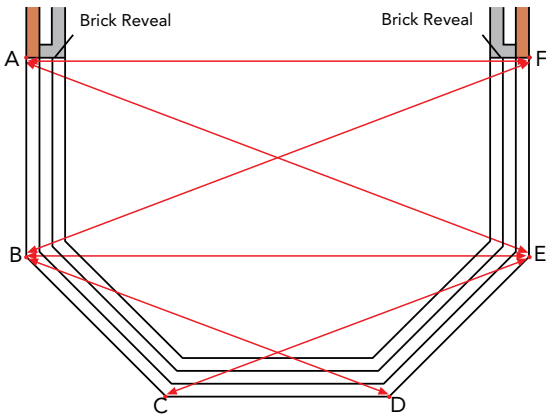

DIMENSIONS REQUIRED	
LINTEL DIMENSIONS	
A to B =	mm
B to C =	mm
C to D =	mm
D to E =	mm
E to F =	mm
A to F =	mm
A to E =	mm
B to F =	mm
B to E =	mm
C to E =	mm
B to D =	mm
PLASTER KEY REQUIRED (Please Tick)	
INSIDE ONLY	<input type="checkbox"/>
BOTH SIDES	<input type="checkbox"/>
NONE	<input type="checkbox"/>
WALL CONSTRUCTION	
OUTER LEAF	mm
CAVITY WIDTH	mm
INNER LEAF	mm
SUPPORT POST	
HEIGHT	mm

NOTE:

Where a Cathedral or Vaulted ceiling is required the IG Ridgebeam Cradle is supplied to support the roof structure and resist roof spread.



EXPLODED ISOMETRIC VIEW

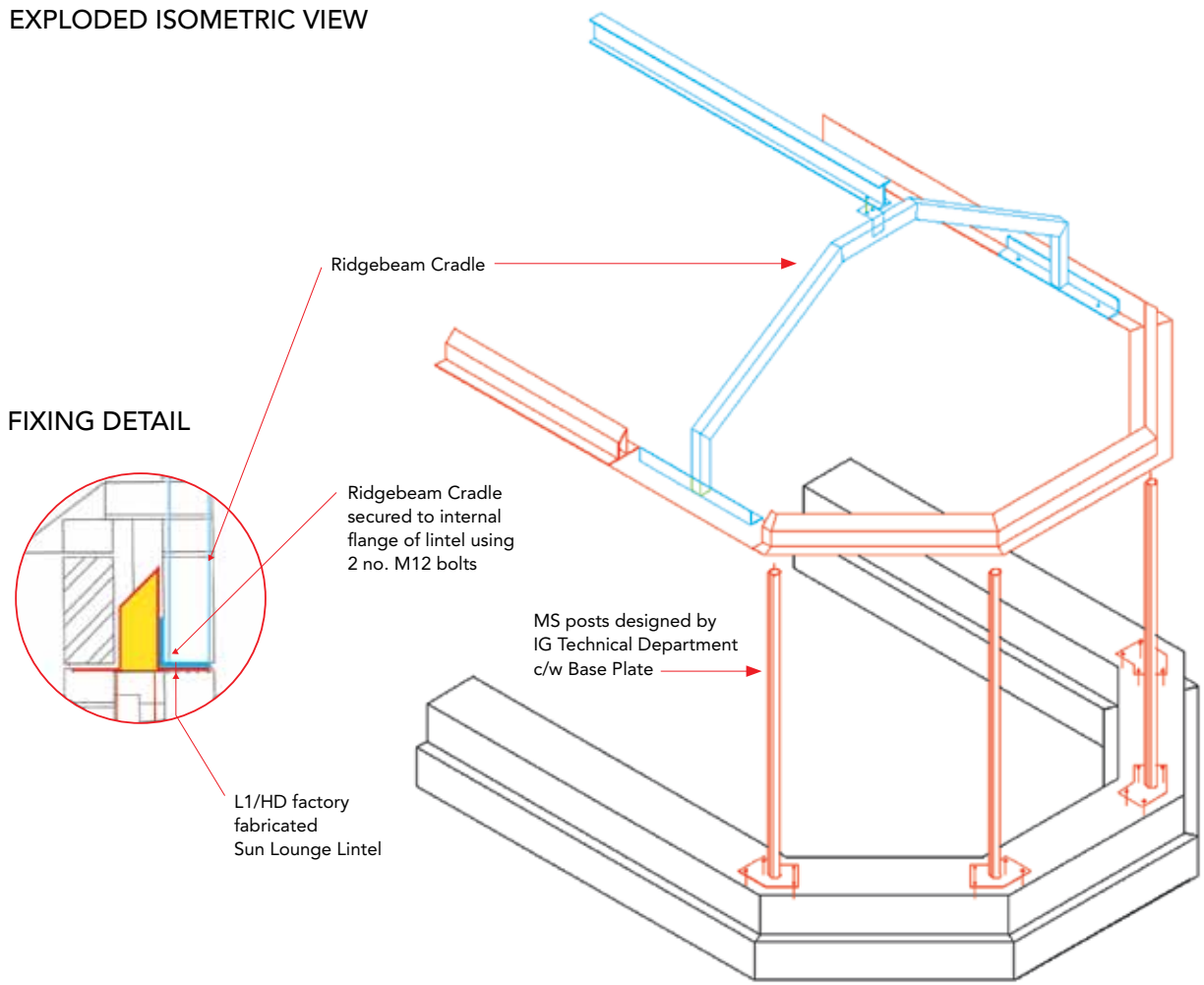

FIXING DETAIL

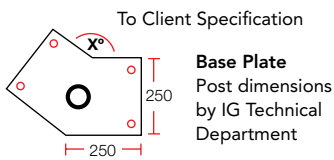
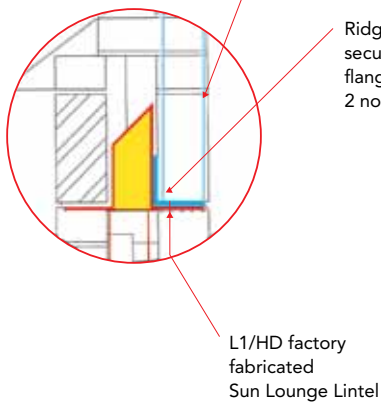

Standard Sun Lounge

Construction Data

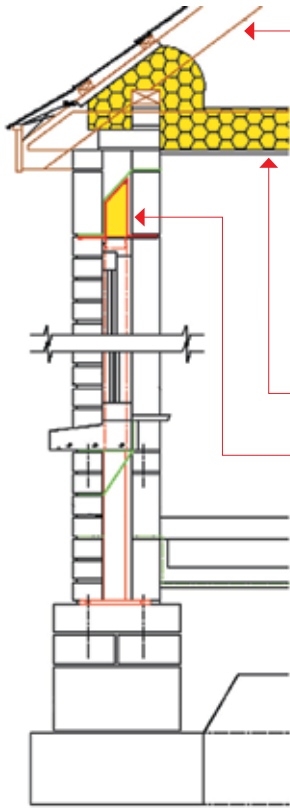

ROOF CONSTRUCTION:

Slates or tiles to match existing on 25x50mm battens on one layer sarking felt on 38x150mm rafters @ 400mm CRS with 38x50mm battens to U/S of rafters to maintain 50mm airgap within roof construction when incorporating 150mm fibre glass quilt insulation. 50x100mm Ridge Plate shot fixed to T/S ridge beam. 50x100mm Wall Plate securely strapped down to wall using 5x30mm galv ms straps by Cullen or equal @ 1200mm CRS. 100x25mm diagonal bracing positioned both sides of roof. 38x100mm collar ties @ 400mm CRS. 50x250mm hip rafters. TG and V redwood sheeting ceiling painted with Class 1 SSF varnish. All structural timber to be C16 or greater and must be stamped accordingly.

STRUCTURAL RIGIDITY:

- Roof Anchorage - First rafter and collar tie to be bolted to main wall at 450mm CRS using Rawl bolts or similar proprietary fixing.
- MS support posts and factory fitted Base Plate to be bolted down on top of solid footings built up to 300mm below finished floor level.
- Racking resistance provided using 9mm plywood secured to U/S of rafters and collar ties prior to any decorative finishes.
- Where a raised or vaulted ceiling is required a IG Ridge Beam Cradle must be used.

LINTEL SPECIFICATION:

IG L1/HD factory fabricated Sun Lounge Lintel supported on MS posts designed by IG Technical Department located as indicated on plan.



SPECIFICATION

IG factory fabricated Sun Lounge Lintel - mitred and welded complete with factory fitted location spigots for easy installation - on MS posts designed by IG Technical Department complete with Base Plates secured to solid footing 300mm below finished floor level.

On large Sun Lounges and in exposed locations the IG Inverted Support Frame is supplied as specified by IG Technical Department.

CONSTRUCTION DETAILS

Provide 150mm fibreglass quilt insulation between roof rafters and collar ties. Insulation to be carried over top of cavity wall and pushed into soffit box to prevent a cold bridge. Install Cullen G400 eaves ventilators to provide a continuous air path for roof space ventilation between roof and insulation and roof underlay at eaves equivalent to 10,000mm²/m with Cullen G1200 over fascia ventilator to provide ventilation to roof space equivalent 10,000mm²/m in accordance with Building Regs. Approved Document F and or BS 5250: 2011. Fixed in accordance with manufacturers instructions.

Provide stepped cavity tray across wall directly above Code No.4 flashing, where new roof abuts wall. Note all lead to be treated with patination oil. Rainwater goods fascia and soffit to match existing. RC cill with DPC @ rear, ends and under. Wall DPC located min. 150mm above ground level. 300mm solid blockwork footings.

250mm x 600mm concrete foundation. Form new opening from existing dwelling into Sun Lounge to client's requirements.

Provide vertical DPC where Sun Lounge window abuts existing wall. Where new wall abuts existing, new cavity to be continuous with existing cavity. Provide 35mm polystyrene insulation between MS post and against inner leaf where post is inside cavity, to prevent a cold bridge. All glazed panels to doors and side panels with glazing less than 1500mm above floor or ground level to be safety glass to BS6206: Class B and C.

Provide 300mm cavity wall construction with 60mm Rigid Polystyrene Insulation - Wall ties with insulation clips to be spaced 750mm horizontal and 450mm vertical CRS. Form new external steps @ doorway to comply with current Building Regs. Any new heating pipes to be insulated with an insulation of thickness of not less than the diameter of the pipe - insulation to BS 5422:2009.

Provide 100mm dia stormwater drain, laid to fall 1:60, drain pipe to be surrounded with 150mm pea gravel. All drain pipes to comply with BS 4660 - connected to existing system.

SAMPLE PLANS

The sample plans include the following drawings and notes:

- Typical Side Elevation (Scale 1:100):** Shows the profile of the Sun Lounge with a gabled roof and large glass panels.
- Typical Front Elevation (Scale 1:100):** Shows the front facade with a central entrance and large glass windows.
- Typical Section (Scale 1:100):** Shows a cross-section of the structure, highlighting the roof structure, insulation, and floor levels.
- Ground Floor Plan (Scale 1:100):** Shows the layout of the Sun Lounge on the ground floor, including the entrance and internal divisions.
- Typical Structural 3D Exploded Cradle Detail (Scale 1:100):** Shows the structural components of the cradle, including the frame and supports.
- Typical Construction 3D Exploded Detail (Scale 1:100):** Shows the construction details of the Sun Lounge, including the roof, walls, and floor.
- Typical Construction Data for Restroom Sun Lounge Type 9:** A table providing technical specifications for the construction.

Notes:

- NOTE 01: All dimensions and levels to be checked by contractor prior to work commencing on site. All dimensions are to be carried out to the top of the finished floor level.
- NOTE 02: All work to be carried out in accordance with the Building Regulations and all other relevant legislation.
- NOTE 03: All work to be carried out in accordance with the Building Regulations and all other relevant legislation.
- NOTE 04: All work to be carried out in accordance with the Building Regulations and all other relevant legislation.
- NOTE 05: All work to be carried out in accordance with the Building Regulations and all other relevant legislation.
- NOTE 06: All work to be carried out in accordance with the Building Regulations and all other relevant legislation.
- NOTE 07: All work to be carried out in accordance with the Building Regulations and all other relevant legislation.
- NOTE 08: All work to be carried out in accordance with the Building Regulations and all other relevant legislation.
- NOTE 09: All work to be carried out in accordance with the Building Regulations and all other relevant legislation.
- NOTE 10: All work to be carried out in accordance with the Building Regulations and all other relevant legislation.
- NOTE 11: All work to be carried out in accordance with the Building Regulations and all other relevant legislation.
- NOTE 12: All work to be carried out in accordance with the Building Regulations and all other relevant legislation.
- NOTE 13: All work to be carried out in accordance with the Building Regulations and all other relevant legislation.
- NOTE 14: All work to be carried out in accordance with the Building Regulations and all other relevant legislation.
- NOTE 15: All work to be carried out in accordance with the Building Regulations and all other relevant legislation.
- NOTE 16: All work to be carried out in accordance with the Building Regulations and all other relevant legislation.
- NOTE 17: All work to be carried out in accordance with the Building Regulations and all other relevant legislation.
- NOTE 18: All work to be carried out in accordance with the Building Regulations and all other relevant legislation.
- NOTE 19: All work to be carried out in accordance with the Building Regulations and all other relevant legislation.
- NOTE 20: All work to be carried out in accordance with the Building Regulations and all other relevant legislation.
- NOTE 21: All work to be carried out in accordance with the Building Regulations and all other relevant legislation.
- NOTE 22: All work to be carried out in accordance with the Building Regulations and all other relevant legislation.
- NOTE 23: All work to be carried out in accordance with the Building Regulations and all other relevant legislation.
- NOTE 24: All work to be carried out in accordance with the Building Regulations and all other relevant legislation.
- NOTE 25: All work to be carried out in accordance with the Building Regulations and all other relevant legislation.
- NOTE 26: All work to be carried out in accordance with the Building Regulations and all other relevant legislation.
- NOTE 27: All work to be carried out in accordance with the Building Regulations and all other relevant legislation.
- NOTE 28: All work to be carried out in accordance with the Building Regulations and all other relevant legislation.
- NOTE 29: All work to be carried out in accordance with the Building Regulations and all other relevant legislation.
- NOTE 30: All work to be carried out in accordance with the Building Regulations and all other relevant legislation.
- NOTE 31: All work to be carried out in accordance with the Building Regulations and all other relevant legislation.
- NOTE 32: All work to be carried out in accordance with the Building Regulations and all other relevant legislation.
- NOTE 33: All work to be carried out in accordance with the Building Regulations and all other relevant legislation.
- NOTE 34: All work to be carried out in accordance with the Building Regulations and all other relevant legislation.
- NOTE 35: All work to be carried out in accordance with the Building Regulations and all other relevant legislation.
- NOTE 36: All work to be carried out in accordance with the Building Regulations and all other relevant legislation.
- NOTE 37: All work to be carried out in accordance with the Building Regulations and all other relevant legislation.
- NOTE 38: All work to be carried out in accordance with the Building Regulations and all other relevant legislation.
- NOTE 39: All work to be carried out in accordance with the Building Regulations and all other relevant legislation.
- NOTE 40: All work to be carried out in accordance with the Building Regulations and all other relevant legislation.
- NOTE 41: All work to be carried out in accordance with the Building Regulations and all other relevant legislation.
- NOTE 42: All work to be carried out in accordance with the Building Regulations and all other relevant legislation.
- NOTE 43: All work to be carried out in accordance with the Building Regulations and all other relevant legislation.
- NOTE 44: All work to be carried out in accordance with the Building Regulations and all other relevant legislation.
- NOTE 45: All work to be carried out in accordance with the Building Regulations and all other relevant legislation.
- NOTE 46: All work to be carried out in accordance with the Building Regulations and all other relevant legislation.
- NOTE 47: All work to be carried out in accordance with the Building Regulations and all other relevant legislation.
- NOTE 48: All work to be carried out in accordance with the Building Regulations and all other relevant legislation.
- NOTE 49: All work to be carried out in accordance with the Building Regulations and all other relevant legislation.
- NOTE 50: All work to be carried out in accordance with the Building Regulations and all other relevant legislation.
- NOTE 51: All work to be carried out in accordance with the Building Regulations and all other relevant legislation.
- NOTE 52: All work to be carried out in accordance with the Building Regulations and all other relevant legislation.
- NOTE 53: All work to be carried out in accordance with the Building Regulations and all other relevant legislation.
- NOTE 54: All work to be carried out in accordance with the Building Regulations and all other relevant legislation.
- NOTE 55: All work to be carried out in accordance with the Building Regulations and all other relevant legislation.
- NOTE 56: All work to be carried out in accordance with the Building Regulations and all other relevant legislation.
- NOTE 57: All work to be carried out in accordance with the Building Regulations and all other relevant legislation.
- NOTE 58: All work to be carried out in accordance with the Building Regulations and all other relevant legislation.
- NOTE 59: All work to be carried out in accordance with the Building Regulations and all other relevant legislation.
- NOTE 60: All work to be carried out in accordance with the Building Regulations and all other relevant legislation.
- NOTE 61: All work to be carried out in accordance with the Building Regulations and all other relevant legislation.
- NOTE 62: All work to be carried out in accordance with the Building Regulations and all other relevant legislation.
- NOTE 63: All work to be carried out in accordance with the Building Regulations and all other relevant legislation.
- NOTE 64: All work to be carried out in accordance with the Building Regulations and all other relevant legislation.
- NOTE 65: All work to be carried out in accordance with the Building Regulations and all other relevant legislation.
- NOTE 66: All work to be carried out in accordance with the Building Regulations and all other relevant legislation.
- NOTE 67: All work to be carried out in accordance with the Building Regulations and all other relevant legislation.
- NOTE 68: All work to be carried out in accordance with the Building Regulations and all other relevant legislation.
- NOTE 69: All work to be carried out in accordance with the Building Regulations and all other relevant legislation.
- NOTE 70: All work to be carried out in accordance with the Building Regulations and all other relevant legislation.
- NOTE 71: All work to be carried out in accordance with the Building Regulations and all other relevant legislation.
- NOTE 72: All work to be carried out in accordance with the Building Regulations and all other relevant legislation.
- NOTE 73: All work to be carried out in accordance with the Building Regulations and all other relevant legislation.
- NOTE 74: All work to be carried out in accordance with the Building Regulations and all other relevant legislation.
- NOTE 75: All work to be carried out in accordance with the Building Regulations and all other relevant legislation.
- NOTE 76: All work to be carried out in accordance with the Building Regulations and all other relevant legislation.
- NOTE 77: All work to be carried out in accordance with the Building Regulations and all other relevant legislation.
- NOTE 78: All work to be carried out in accordance with the Building Regulations and all other relevant legislation.
- NOTE 79: All work to be carried out in accordance with the Building Regulations and all other relevant legislation.
- NOTE 80: All work to be carried out in accordance with the Building Regulations and all other relevant legislation.
- NOTE 81: All work to be carried out in accordance with the Building Regulations and all other relevant legislation.
- NOTE 82: All work to be carried out in accordance with the Building Regulations and all other relevant legislation.
- NOTE 83: All work to be carried out in accordance with the Building Regulations and all other relevant legislation.
- NOTE 84: All work to be carried out in accordance with the Building Regulations and all other relevant legislation.
- NOTE 85: All work to be carried out in accordance with the Building Regulations and all other relevant legislation.
- NOTE 86: All work to be carried out in accordance with the Building Regulations and all other relevant legislation.
- NOTE 87: All work to be carried out in accordance with the Building Regulations and all other relevant legislation.
- NOTE 88: All work to be carried out in accordance with the Building Regulations and all other relevant legislation.
- NOTE 89: All work to be carried out in accordance with the Building Regulations and all other relevant legislation.
- NOTE 90: All work to be carried out in accordance with the Building Regulations and all other relevant legislation.
- NOTE 91: All work to be carried out in accordance with the Building Regulations and all other relevant legislation.
- NOTE 92: All work to be carried out in accordance with the Building Regulations and all other relevant legislation.
- NOTE 93: All work to be carried out in accordance with the Building Regulations and all other relevant legislation.
- NOTE 94: All work to be carried out in accordance with the Building Regulations and all other relevant legislation.
- NOTE 95: All work to be carried out in accordance with the Building Regulations and all other relevant legislation.
- NOTE 96: All work to be carried out in accordance with the Building Regulations and all other relevant legislation.
- NOTE 97: All work to be carried out in accordance with the Building Regulations and all other relevant legislation.
- NOTE 98: All work to be carried out in accordance with the Building Regulations and all other relevant legislation.
- NOTE 99: All work to be carried out in accordance with the Building Regulations and all other relevant legislation.
- NOTE 100: All work to be carried out in accordance with the Building Regulations and all other relevant legislation.

Special Arch Lintel Enquiry Fax Form

Please complete all details and submit to IG Technical Department on fax **01633 486495** or email **technical@iglintels.com**

Name: _____ Company: _____
 Tel: _____ Mobile: _____
 Email: _____
 Job Ref: _____ Site Name: _____
 Site Address: _____

 Post Code: _____

Full Arch Lintel

LINTEL DIMENSIONS		
CLEAR SPAN (a)		mm
RISE (r)		mm
END BEARING (c)		mm
PLASTER KEY REQUIRED (Please Tick)		
INSIDE ONLY		
BOTH SIDES		
NONE		
WALL CONSTRUCTION	LOAD	
OUTER LEAF	mm	kN/m
CAVITY WIDTH	mm	-
INNER LEAF	mm	kN/m

APPLICATION DETAILS (if known)	
MASONRY HEIGHT	mm
ROOF SPAN	mm
FLOOR TYPE	Concrete / Timber
FLOOR SPAN	mm

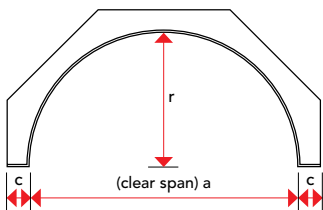

Segmental Arch Lintel

LINTEL DIMENSIONS		
CLEAR SPAN (a)		mm
RISE (r)		mm
END BEARING (c)		mm
PLASTER KEY REQUIRED (Please Tick)		
INSIDE ONLY		
BOTH SIDES		
NONE		
WALL CONSTRUCTION	LOAD	
OUTER LEAF	mm	kN/m
CAVITY WIDTH	mm	-
INNER LEAF	mm	kN/m

APPLICATION DETAILS (if known)	
MASONRY HEIGHT	mm
ROOF SPAN	mm
FLOOR TYPE	Concrete / Timber
FLOOR SPAN	mm

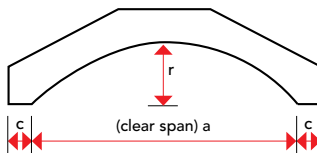

Parabolic Arch Lintel

LINTEL DIMENSIONS		
CLEAR SPAN (a)		mm
RISE (r)		mm
END BEARING (c)		mm
PLASTER KEY REQUIRED (Please Tick)		
INSIDE ONLY		
BOTH SIDES		
NONE		
WALL CONSTRUCTION	LOAD	
OUTER LEAF	mm	kN/m
CAVITY WIDTH	mm	-
INNER LEAF	mm	kN/m

APPLICATION DETAILS (if known)	
MASONRY HEIGHT	mm
ROOF SPAN	mm
FLOOR TYPE	Concrete / Timber
FLOOR SPAN	mm

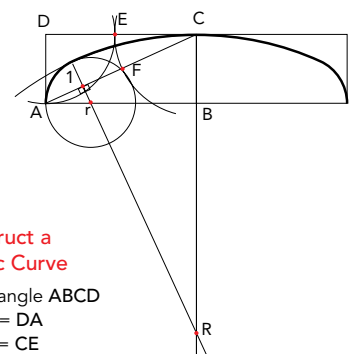
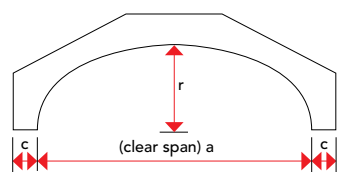

To construct a Parabolic Curve

Draw rectangle ABCD
 Make DE = DA
 Make CF = CE
 Bisect AF to make point 1
 Project a right angle off AF at point 1 to find small radius r, and project further to find large radius R

Special Arch Lintel Enquiry Fax Form

BETTER BY
DESIGN

Please complete all details and submit to IG Technical Department
on fax **01633 486495** or email **technical@iglintels.com**

Name: _____ Company: _____
 Tel: _____ Mobile: _____
 Email: _____
 Job Ref: _____ Site Name: _____
 Site Address: _____
 Post Code: _____



Gothic Arch Lintel

LINTEL DIMENSIONS		
CLEAR SPAN (a)	mm	
RISE (r)	mm	
END BEARING (c)	mm	
PLASTER KEY REQUIRED (Please Tick)		
INSIDE ONLY	<input type="checkbox"/>	
BOTH SIDES	<input type="checkbox"/>	
NONE	<input type="checkbox"/>	
WALL CONSTRUCTION		LOAD
OUTER LEAF	mm	kN/m
CAVITY WIDTH	mm	-
INNER LEAF	mm	kN/m
SINGLE RADIUS (if known)		
RADIUS	mm	
DOUBLE RADIUS (if known)		
LARGE RADIUS	mm	
SMALL RADIUS	mm	

APPLICATION DETAILS (if known)	
MASONRY HEIGHT	mm
ROOF SPAN	mm
FLOOR TYPE	Concrete / Timber
FLOOR SPAN	mm

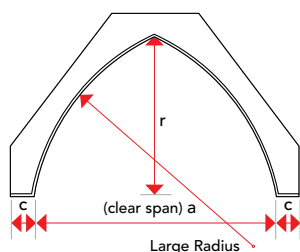
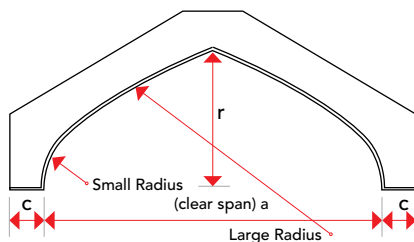

Venetian Arch Lintel

LINTEL DIMENSIONS		
OVERALL CLEAR SPAN (a1)	mm	
CLEAR SPAN (a2)	mm	
RISE (r)	mm	
END BEARING (c)	mm	
PLASTER KEY REQUIRED (Please Tick)		
INSIDE ONLY	<input type="checkbox"/>	
BOTH SIDES	<input type="checkbox"/>	
NONE	<input type="checkbox"/>	
SUPPORT POSTS (if required)		
HEIGHT	mm	
WALL CONSTRUCTION		LOAD
OUTER LEAF	mm	kN/m
CAVITY WIDTH	mm	-
INNER LEAF	mm	kN/m

APPLICATION DETAILS (if known)	
MASONRY HEIGHT	mm
ROOF SPAN	mm
FLOOR TYPE	Concrete / Timber
FLOOR SPAN	mm

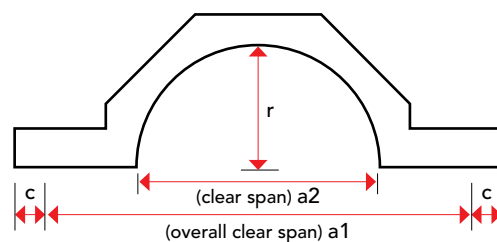

This fax back form may be downloaded from iglintels.com/support or alternatively you may submit your enquiry on-line in our Special Lintels section www.iglintels.com/special-lintels

Special Mitred Lintel Enquiry Fax Form

Please complete all details and submit to IG Technical Department
on fax **01633 486495** or email **technical@iglintels.com**



Name: _____ Company: _____

Tel: _____ Mobile: _____

Email: _____

Job Ref: _____ Site Name: _____

Site Address: _____

Post Code: _____

Apex Lintel

LINTEL DIMENSIONS		
CLEAR SPAN (a)	mm	
RISE (r)	mm	
END BEARING (c)	mm	
PLASTER KEY REQUIRED (Please Tick)		
INSIDE ONLY		
BOTH SIDES		
NONE		
WALL CONSTRUCTION	LOAD	
OUTER LEAF	mm	kN/m
CAVITY WIDTH	mm	-
INNER LEAF	mm	kN/m

APPLICATION DETAILS (if known)	
MASONRY HEIGHT	mm
ROOF SPAN	mm
FLOOR TYPE	Concrete / Timber
FLOOR SPAN	mm

Apex Lintel

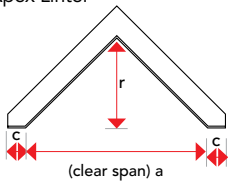

Half Apex Lintel

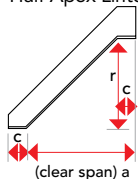

Bay Lintel

LINTEL DIMENSIONS		
A to B =	mm	
B to C =	mm	
C to D =	mm	
PLASTER KEY REQUIRED (Please Tick)		
INSIDE ONLY		
BOTH SIDES		
NONE		
WALL CONSTRUCTION	LOAD	
OUTER LEAF	mm	kN/m
CAVITY WIDTH	mm	-
INNER LEAF	mm	kN/m
SUPPORT POST		
HEIGHT	mm	

APPLICATION DETAILS (if known)	
MASONRY HEIGHT	mm
ROOF SPAN	mm
FLOOR TYPE	Concrete / Timber
FLOOR SPAN	mm

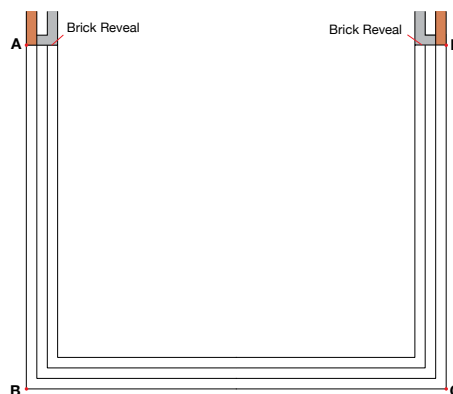

Corner Lintel

LINTEL DIMENSIONS		
A to B =	mm	
B to C =	mm	
A to C =	mm	
PLASTER KEY REQUIRED (Please Tick)		
INSIDE ONLY		
BOTH SIDES		
NONE		
WALL CONSTRUCTION	LOAD	
OUTER LEAF	mm	kN/m
CAVITY WIDTH	mm	-
INNER LEAF	mm	kN/m
SUPPORT POST		
HEIGHT	mm	

APPLICATION DETAILS (if known)	
MASONRY HEIGHT	mm
ROOF SPAN	mm
FLOOR TYPE	Concrete / Timber
FLOOR SPAN	mm

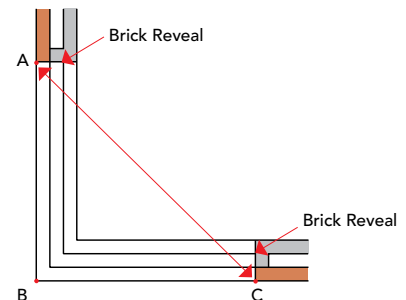

Special Plan Radius Lintel Enquiry Fax Form

BETTER BY
DESIGN

Please complete all details and submit to IG Technical Department on **fax 01633 486495** or email **technical@iglintels.com**

Name: _____ Company: _____

Tel: _____ Mobile: _____

Email: _____

Job Ref: _____ Site Name: _____

Site Address: _____

Post Code: _____



Bow Lintel

LINTEL DIMENSIONS		
A to B =		mm
C to D =		mm
REVEALS (Please Tick)		
PROJECTING		
RETURNED		
PLASTER KEY REQUIRED (Please Tick)		
INSIDE ONLY		
BOTH SIDES		
NONE		
WALL CONSTRUCTION		LOAD
OUTER LEAF	mm	kN/m
CAVITY WIDTH	mm	-
INNER LEAF	mm	kN/m
SUPPORT POST		
HEIGHT		mm

APPLICATION DETAILS (if known)	
MASONRY HEIGHT	mm
ROOF SPAN	mm
FLOOR TYPE	Concrete / Timber
FLOOR SPAN	mm

Bow Lintel with
Projecting Reveals

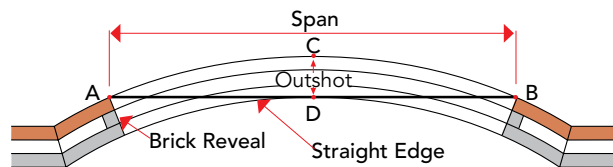

Bow Lintel with
Non Projecting Reveals

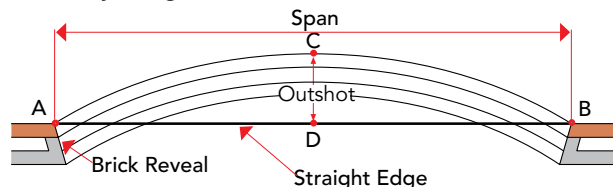

For more information on other special lintels, please complete contact details above, tick lintel type and submit to IG Technical Department on **fax 01633 486495** or email **technical@iglintels.com**

- | | |
|---|--|
| <input type="checkbox"/> CORNER POST | <input type="checkbox"/> CANT BRICK LINTEL |
| <input type="checkbox"/> TIMBER ARCH LINTEL | <input type="checkbox"/> STEPPED LINTEL |
| <input type="checkbox"/> NOTCHED LINTEL | <input type="checkbox"/> DOUBLE GOTHIC ARCH LINTEL |
| <input type="checkbox"/> END PLATED LINTEL | <input type="checkbox"/> I BEAMS |

This fax back form may be downloaded from iglintels.com/support or alternatively you may submit your enquiry on-line in our Special Lintels section www.iglintels.com/special-lintels

BETTER BY
DESIGN

IG
STEEL LINTELS

Hi-Therm

IG has redefined Lintel performance with Hi-Therm, designed to exceed the thermal requirements in forthcoming building regulations. Hi-Therm is supported by an advanced technical service package.

Special Lintels

IG offer a complete custom design service to ensure your project has the best lintel for the job. Our technical expertise is renowned for delivering solutions with total efficiency.

Masonry Support & Windposts

IG continues to set the standard for masonry support and windpost systems for a range of building frame configurations. The innovative Qwik Fix angle provides a versatile solution when masonry support is required.

Standard Lintels

IG produce a wide range of standard galvanised steel and stainless steel lintels. All IG standard lintels satisfy the Thermal Performance requirements of all UK building regulations.

Brickwork Feature Lintels

IG Brickwork Feature Lintels are a one piece prefabricated unit, manufactured bespoke to order, achieving even the most challenging architectural designs.

Cavity Trays

The IG Cavity Tray presents a lightweight, simple to install and long-lasting solution to preventing dampness from penetrating below the roof line.

www.iglintels.com

LINTEL HOTLINE

01633 486486

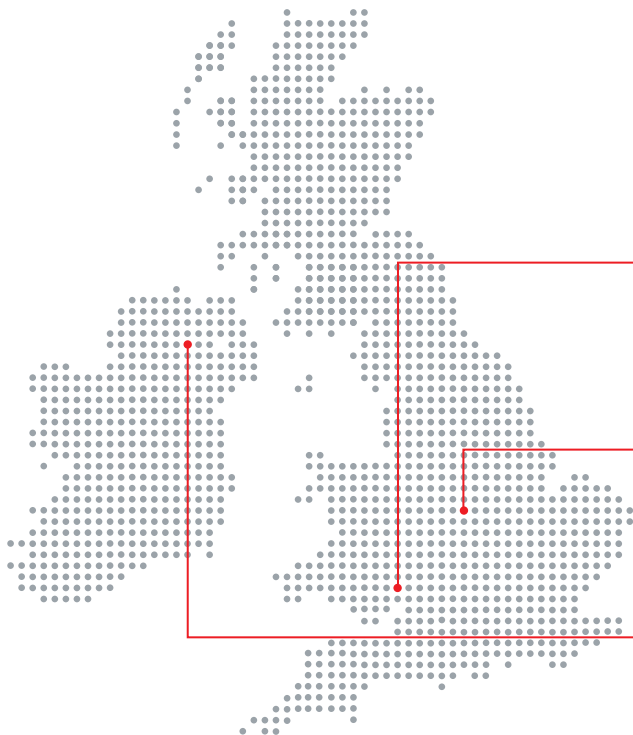

IG - CWMBRAN

Avondale Road, Cwmbran,
Gwent, NP44 1XY
T: +44 (0) 1633 486486
F: +44 (0) 1633 486465



IG - SWADLINCOTE

Ryder Close, Cadley Hill Industrial Estate
Swadlincote, South Derbyshire DE11 9EU
T: +44 (0) 1283 200150
F: +44 (0) 1283 223352



IG - IRELAND

Ballyreagh Industrial Estate,
Cookstown, Co. Tyrone BT80 9DG
T: +44 (0) 28 86762184
F: +44 (0) 28 86761011

